

DUALCOMP BEDLINER INSTALLS IN 5 MINUTES OR LESS!

**The Dualcomp Bedliner can be assembled with just one screw driver!
Simply fit the five components together and you are ready to go!**

**The Front Bulkhead Clips Over
The Front Of Your Pickup Box**



Slip the Sides Into Place



**The Sides Are Attached To The Front
With The Automotive Fasteners**

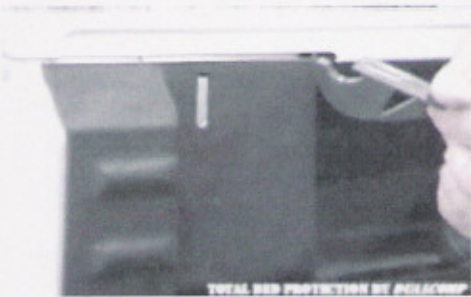

**The Floor Mat Is Fitted Into The Side
Receiving Channels**



Install Tail Gate Protection



**You're Done!
Enjoy The Best Skid Resistant Bedliner Ever!**



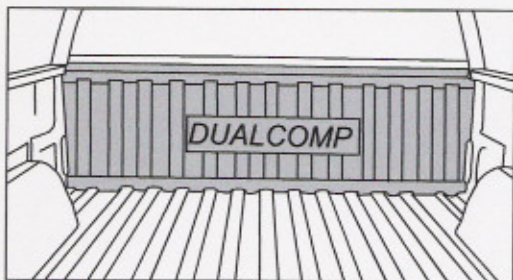

1. Install front section. Slide down over front rail.

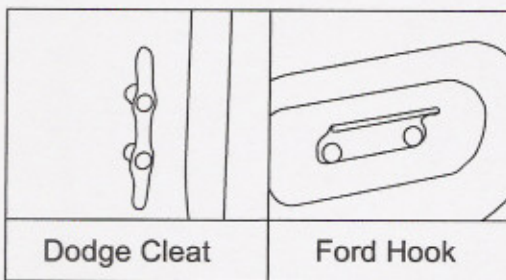

Dodge Cleat

Ford Hook

2. Ford and Dodge - remove tie down hooks or cleats. GM hooks are not removable.

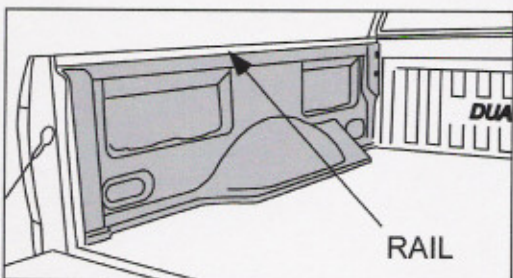

3. Tuck top of the sidewall under rail and push the bottom toward side of bed. On GM models, push panel past tie-down hooks.

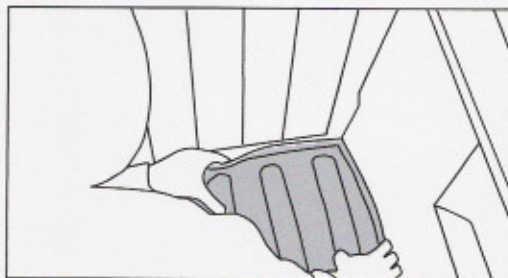

4. Tuck mat into channel starting at front. **Make sure mat is installed as far forward as possible.**

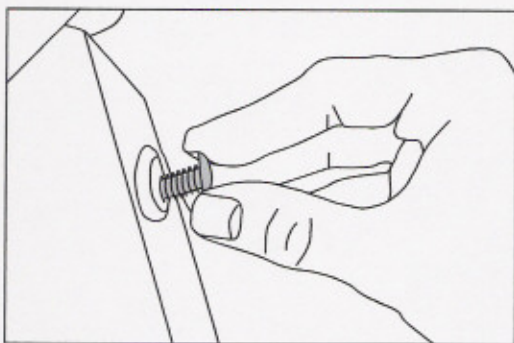

5. Push in 4 plastic clips to join sidewalls to front section.

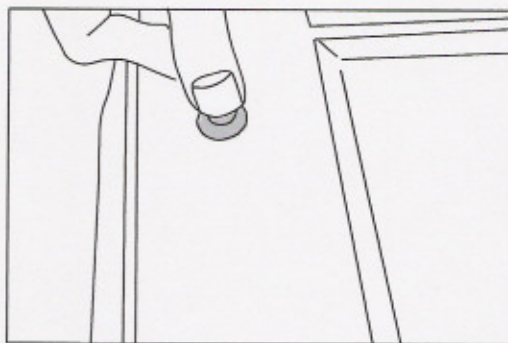

6. Install tailgate cover using the hatch or handle screws (Dodge and Ford - hatch GM - handle). Then drill 1/4" holes in tailgate using locations in tailgate cover. Coat exposed metal with rust proofing then push in plastic clips.